

Minimum hook, bend and radius allowances for steel bars that comply with SANS 920: 2005

High Yield Stress Steel Bars

Bends that form end anchorages - Shape code 42

Semi circular hooks - Shape Code 72

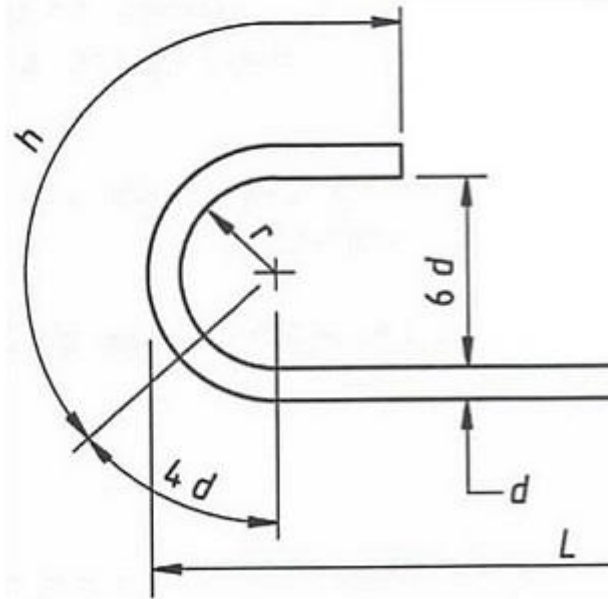
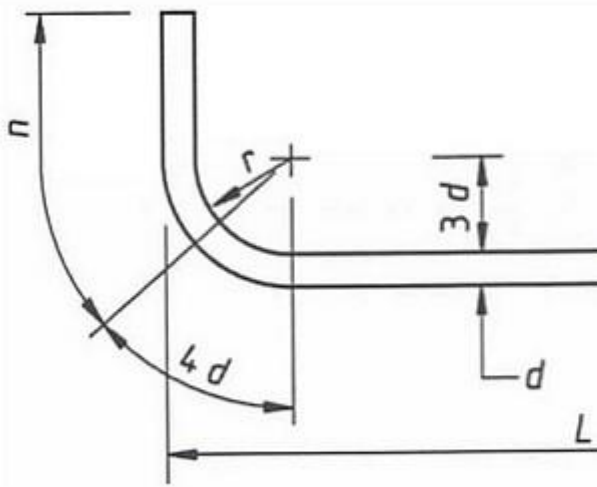

Cutting length of bar equals $L + n$

Cutting length of bar equals $L + h$

Nominal size of bar	d	10	12	16	20	25	32	40
Hook allowance	h	180	210	240	280	340	400	480
Bend allowance	n	130	130	150	170	190	220	250
Radius	r	30	36	48	60	75	96	120

Minimum hook, bend and radius allowances for steel bars that comply with SANS 920: 2005

0

Minimum hook, bend and radius allowances for steel bars that comply with SANS 920: 2005

Hot-Rolled Mild Steel Bars

Bends that form end anchorages - Shape code 42

Semi circular hooks - Shape Code 72

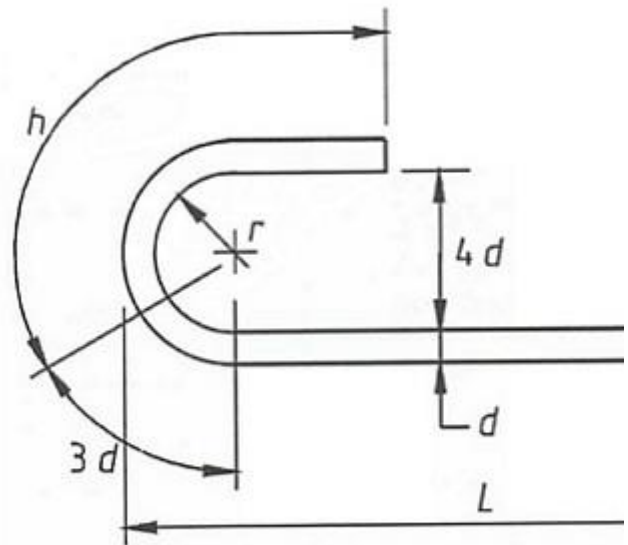
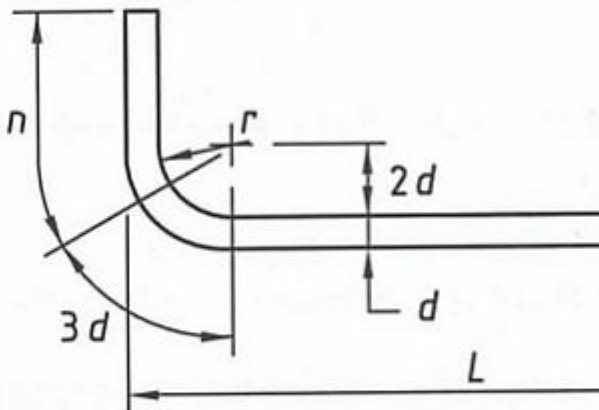

Cutting length of bar equals $L + n$

Cutting length of bar equals $L + h$

Nominal size of bar	d	8	10	12	16	20	25	32	40
Hook allowa	h	10	14	17	19	21	24	29	36

**Minimum hook, bend and radius allowances for steel bars that
comply with SANS 920: 2005**

nce		0	0	0	0	0	0	0	0
Bend allowa nce	n	10 0	10 0	10 0	12 0	13 0	15 0	18 0	20 0
Radius	r	16	20	24	32	40	50	64	80